

THE GARDENS

TAHMOOR

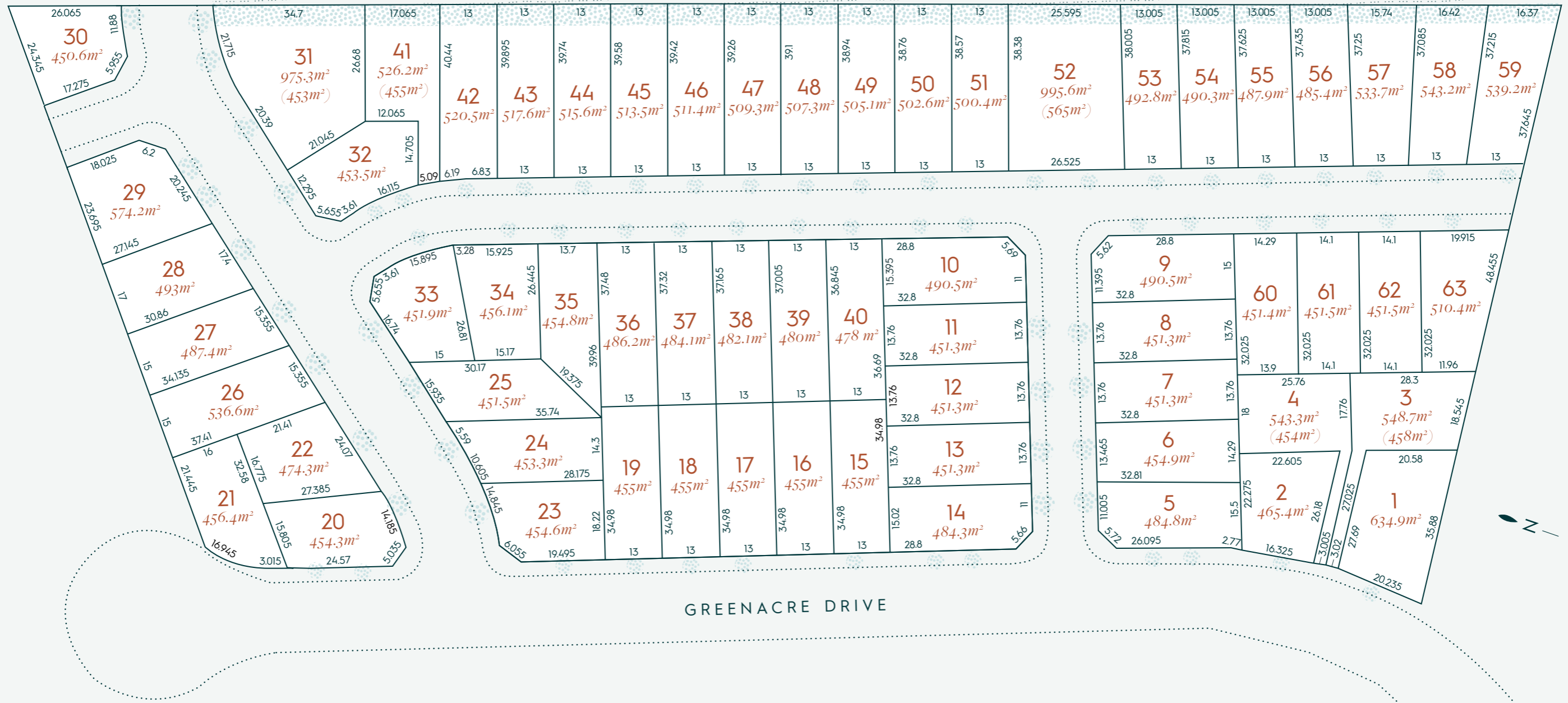

GREENACRE DRIVE

PRE-CONSTRUCTION

- HIA fixed site works.
- Plans - Specifications.
- Engineers soil report & slab design.
- Council building application fees

SITE WORKS FOUNDATIONS & CONNECTIONS

- Site scrape and/or balanced cut & fill excavation for up to 1500mm site fall over the building platform.
- Engineer designed concrete slab to suit up to "H2" slab with bulk concrete piling (up to and including a depth of 600mm).
- Termite treatment to slab penetrations and physical perimeter barrier.
- Sewer & storm water connections to existing serviceable connection points for sites up to 600m² in size with a standard.
- 6 meter set back from front boundary (battle-axe, other odd shaped blocks and blocks where service connection exceeds standard allowances may incur extra service costs).
- Eight (8) meters plan length of electrical mains.
- Water connection from pre-tapped water main up to and including six (6) meter setback to house.
- House constructed for "N2" wind rating conditions (W33).
- No allowance is made for retaining walls.

ENERGY EFFICIENCY

- Bulk ceiling insulation rating R2.5 to ceiling area.
- Double sided foil wall-wrap to external stud walls.
- Energy efficient aluminium improved windows and sliding door units
- Weather stripping to hinged external doors.
- Electric hot water system.
- 500 KPA water pressure limiting device.

- LED down-lights.
- Approximately 1.8kw solar power system.

BRICKS, WINDOWS, ROOF AND GARAGE

- Colorbond roof.
- Colorbond fascia & gutter from the standard builders' range of colours.
- Select range of clay bricks from the builder's standard range.
- Off white mortar.
- Powder coated aluminium windows from the standard builders' range of colours, with obscure glass to wet areas.
- Keyed window locks to all opening sashes and sliding doors.
- Auto Sectional garage door to garage from the standard builders' range of colours and two (2) handsets.

KITCHEN INCLUSIONS

- 20mm manufactured stone bench top.
- Soft close cabinetry to cupboards.
- Laminate finish cupboards from the standard builder's range of laminates.
- Door handles from the standard builder's range.
- Laminate finish microwave oven provision to cabinetry.
- 600mm under-bench oven.
- Electric ceramic 600mm cooktop.
- Freestanding stainless-steel dishwasher.
- Stainless steel 600mm slide-out rangehood.
- 1¾ bowl stainless steel kitchen sink.
- Chrome sink mixer.
- Cold water point to fridge space for an ice maker.
- Bulkhead above kitchen overhead cupboards.

BATHROOM ENSUITE AND TOILETS

- Wall-hung vanities with laminate bench

Initial _____

tops from the standard builder's range of laminates.

- Soft close cabinetry to cupboards.
- Door handles from the standard builder's range.
- Clear laminated glass shower screens with powder coated aluminium frames from the standard builder's range of colours.
- White acrylic bath.
- 900mm high polished edge mirrors fitted to the same width as the vanity unit.
- Chrome mixer tapware, double towel rails and toilet roll holders.
- Vitreous China close coupled toilet suites.
- Semi-inset basins (or semi recessed as required).
- Shower on rail to bathroom and ensuite showers.

CERAMIC TILING

- Bathroom & ensuite floors, and:
 - 2000mm high to showers
 - 500mm above bath (nominal)
 - 200mm skirting tile.
- Kitchen tiled splashback:
 - 600mm high off bench.
- Toilet & Laundry floors, and:
 - 400mm splash back over tub
 - 200mm skirting tiles
- No allowance has been made for frieze or decorator tiles.
- No allowance has been made for laying of border tiles, 45-degree patterns or floor feature tile layouts.

ELECTRICAL

- Earth leakage safety switch & circuit breakers.
- Single phase underground power connection from existing supply point.
- Meter box will be installed on the side nearest to the mains connection point.
- One (1) double power point to each room and

as per electrical plan.

- One (1) 240-volt downlight point to each room as per electrical plan.
- Two (2) external para-flood light points.
- Two (2) television points complete with 5 lineal meters of cable and no antenna.
- Smoke detectors hard wired with battery backup.
- Pre-wiring for two (2) Telstra phone points.
- Exhaust fan to bathroom and ensuite.
- Single GPO to microwave oven provision in kitchen.
- USB/double power point to the end of kitchen cabinetry.

STANDARD INTERNAL AND EXTERNAL FEATURES

- 2550mm ceiling heights throughout (ground level only in 2 storey homes).
- Round aluminium powder-coated handrail and vertical balustrade to external balcony as selected from builders' standard range where applicable.
- Paint grade front door with clear glazing.
- Paint grade hinged doors to other external doors if applicable.
- Paint grade flush panel internal passage doors.
- Magnetic door stops from builders' standard range to passage doors.
- Vinyl sliders from builders' standard range to wardrobe doors.
- Builders range exterior leverset to front door
- Interior leverset to internal doors.
- 90mm paint grade coved cornice.
- 41mm paint grade splayed architraves.
- 67mm paint grade splayed skirting.
- Paint:
 - Three (3) coat internal paint system - 2 colours allowed i.e. 1 colour to wall and 1 colour to timber work,
 - Two (2) coats to ceiling to Paint Manufacturers standard specifications,