

a/c condenser to be wall mounted

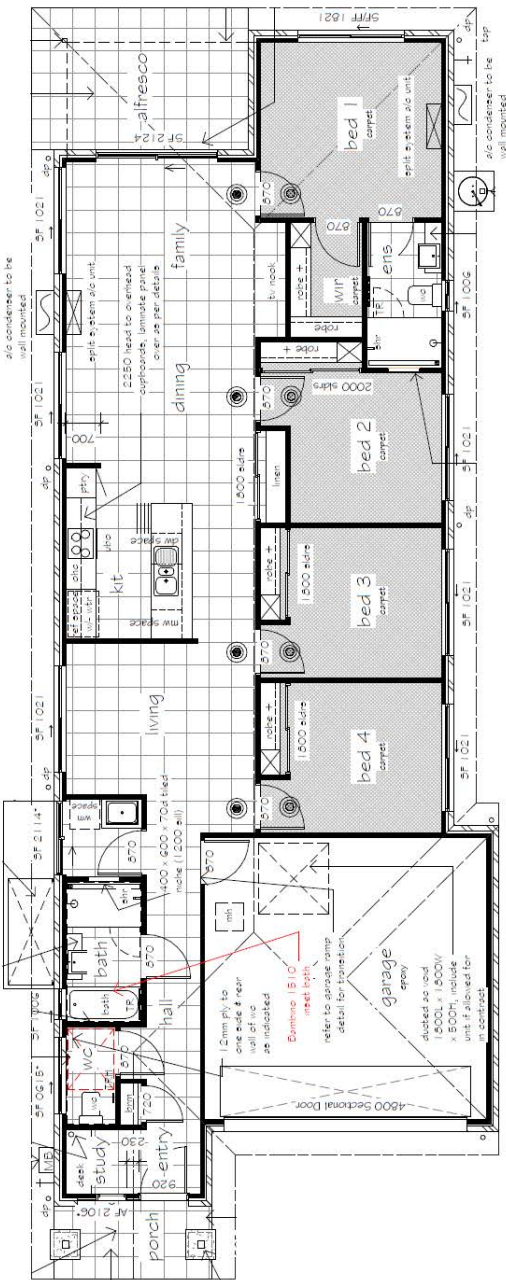

a/c condenser to be wall mounted

split system a/c unit

2250 head to overhead cupboards, laminate panel over as per details

12mm ply to one side of rear wall of wc as indicated

Dormino 1510 inset bath refer to garage ramp detail for transition

ducted a/c void 1500L x 1500W x 500H, include unit if allowed for in contract

4500 Sectional Door

epoxy

carpet

carpet

carpet

carpet